

Fast lift as standard
(up to 120 kg)

Compact and manoeuvrable

Robust and reliable

Unique controls

Particularly quiet operation



AM 15l

Hand pallet truck with flat forks (1,500 kg)

The AM 15l is ideally suited for pallets with a lower entry height. The lowered height of 51 mm allows a large number of flat and special pallets to be handled. Despite the low entry height, the AM 15l has a ground clearance of 13 mm. This means that slightly uneven surfaces can be easily negotiated.

The controls are easy to reach and extremely ergonomic, thus

offering safe movement of the hand pallet truck in all situations.

The standard fast lift function (active up to 120 kg) with automatic changeover always provides optimum operating force. Just a few pump strokes are enough to raise the pallet clear of the floor. This saves time and money and increases efficiency.

 **JUNGHEINRICH**

AM 15l

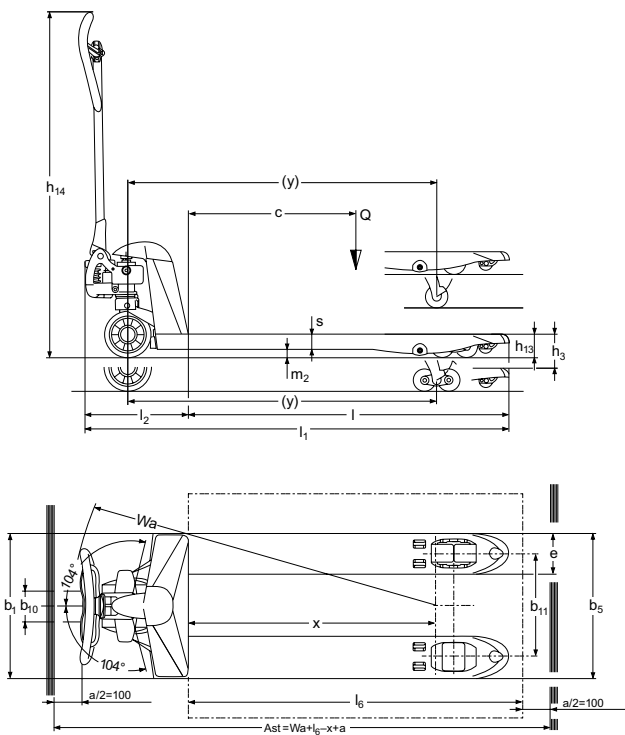

Technical data in line with VDI 2198

| | | | | | | |
|------------------|------|--|-----------------------------------|------------------------------|------------------------------|--------------------------------|
| Identification | 1.1 | Manufacturer (abbreviation) | | Jungheinrich | | |
| | 1.2 | Model | | AM 15I | | |
| | 1.3 | Drive | | manual | | |
| | 1.4 | Manual, pedestrian, stand-on, seated, order picker operation | | hand | | |
| | 1.5 | Load capacity/rated load | Q t | 1.5 | | |
| | 1.6 | Load centre distance | c mm | 400 | 500 | 600 |
| | 1.8 | Load distance | x mm | 525 | 680 | 880 |
| | 1.9 | Wheelbase | y mm | 745 | 900 | 1,100 |
| Weights | 2.1 | Net weight | kg | 71 | 72 | 74 |
| | 2.3 | Axle loading, unladen front/rear | kg | | 60 / 28 | |
| | | | | | | |
| Wheels / frame | 3.1 | Tyres | | C, N | | |
| | 3.2 | Tyre size, front | mm | Ø 170x50 | | |
| | 3.3 | Tyre size, rear | mm | Ø 50x70 | | |
| | 3.5 | Wheels, number front/rear (x = driven wheels) | | 2/4 | | |
| | 3.6 | Tread width, front | b ₁₀ mm | 109 | | |
| | 3.7 | Tread width, rear | b ₁₁ mm | 370 | | |
| | | | | | | |
| Basic dimensions | 4.4 | Lift | h ₃ mm | 120 | | |
| | 4.9 | Height of tiller in drive position min. / max. | h ₁₄ mm | 1,237 | | |
| | 4.14 | Standing height raised | h ₁₂ mm | 171 | | |
| | 4.15 | Height, lowered | h ₁₃ mm | 51 | | |
| | 4.19 | Overall length | l ₁ mm | 1,175 | 1,330 | 1,530 |
| | 4.20 | Length to face of forks | l ₂ mm | 380 | | |
| | 4.21 | Overall width | b ₁ /b ₂ mm | 520 ¹⁾ | | |
| | 4.22 | Fork dimensions | s/e/l mm | 38 / 150 / 795 ²⁾ | 38 / 150 / 950 ²⁾ | 38 / 150 / 1,150 ²⁾ |
| | 4.25 | Width across forks | b ₅ mm | 520 ¹⁾ | | |
| | 4.32 | Ground clearance, centre of wheelbase | m ₂ mm | 13 | | |
| | 4.33 | Aisle width for pallets 1000 x 1200 crossways | Ast mm | 1,584 | | |
| | 4.34 | Aisle width for pallets 800 x 1200 lengthways | Ast mm | 1,784 | | |
| Performance data | 4.35 | Turning radius | W _a mm | 1,274 | | |
| | 5.3 | Lowering speed, laden/unladen | m/s | 0.09 / 0.02 | | |
| | | | | | | |
| | | | | | | |

¹⁾ 680 mm also possible

²⁾ Other fork lengths available

In accordance with VDI Guideline 2198, this data sheet provides details of the standard truck only. Non-standard tyres, different masts, optional equipment, etc. may result in different values.

Benefit from the advantages



Low profile, sturdy forks



Ergonomic operating handle



Permanently lubricated joints for maintenance-free operation

Special lowered height

The lowered height of 51 mm makes the AM 15l ideal for use with pallets which have particularly low entry heights.

Easy to operate

The easy-to-use controls are suitable for both left and right-handed operators. The special lowering valve enables loads

to be lowered precisely. The standard fast lift function (up to 120 kg) ensures that pallets can be lifted clear of the floor with just a few pump strokes.

Compact and manoeuvrable

The front-end length of just 380 mm allows for reliable and easy operation, even in very confined spaces.

Quiet and robust

The sturdy bushes on the wheels and joints ensure the truck runs quietly has a long life. Joints no longer require lubrication; despite this, the AM 15l still runs smoothly and reliably.

Jungheinrich UK Ltd.

Head Office:
Sherbourne House
Sherbourne Drive
Tilbrook
Milton Keynes MK7 8HX
Telephone 01908 363100
Fax 01908 363180

info@jungheinrich.co.uk
www.jungheinrich.co.uk

The German production facilities in Norderstedt, Moosburg and Landsberg are certified. **ISO 9001**
ISO 14001

Jungheinrich fork lift trucks meet European safety requirements.



JUNGHEINRICH